



# *farmtec*

*Spading machines*



*Agri*



Melkweg 2, 2971 VK Bleskensgraaf  
 Tel. +31 (0) 184 692732 [www.farmtec.eu](http://www.farmtec.eu)  
 E: [info@farmtec.eu](mailto:info@farmtec.eu)



*The Spading machine for the Agriculture*



# For a better soil structure



The new AGRI spading machines, designed and introduced by FARMTEC, are the result of more than 30 years development and experience in all kinds of soil. The unique bladesystem in this AGRI, breaks up and turns the soil, removes the ploughpan and improves the soilstructure, assuring a uniform crop with high yields. The water storage capacity from the soil is improved and capillary action maintained. Mounted with a rotary tiller, power harrow or harrow-roller, a homogeneous and level seedbed is being created in only one pass and in combination with a seeder, the capacity is very high. No compacted soil or wheel-tracks are left behind at the surface.

The new AGRI spading machine is suitable for clay, loam, peat and sandy soil. For each type of soil, a suitable blade is available. The AGRI has a unique external gearbox and a planetair reduction gear inside the rotorshaft. This very strong compact and narrow geardrive, makes it possible that transport width and working width are nearly the same and that no marks are left in the field, as conventional sidegears tend to do. The AGRI may-be extended at the rear with other equipment like, rake, spike roller, reversing roller, or any other roller.

Technical features		AGRI 250	AGRI 300	AGRI 300 D	AGRI 350	AGRI 350 D	AGRI 400 D	AGRI 500 D
Working width	cm	250	300	300	350	350	400	500
Transport width	cm	269	319	319	369	369	419	519
Weight (spader only)	kg	1940	2120	2520	2270	2670	2790	3090
Working depth	cm	15 - 35	15 - 35	15 - 35	15 - 35	15 - 35	15 - 35	15 - 35
Rotor diameter	cm	100	100	100	100	100	100	100
Rotor rpm at 1000 PTO	rpm	89	89	89	89	89	89	89
Power	hp/kw	85-250/62-185	100-300/75-220	100-400/75-300	130-300/95-220	130-500/95-370	180-500/130-370	200-500/150-370
Max working speed (light soil/heavy soil)	km/h	9 / 7	9 / 7	9 / 7	9 / 7	9 / 7	9 / 7	9 / 7
Number of blades		18/36	22/44	22/44	26/52	26/52	30/60	36/72
Adjustable depth control discs		option	option	option	option	option	option	option
Alpego power harrow		option	option	option	option	option	option	option
Farmtec rotary tiller		option	option	option	option	option	option	option
Farmtec harrow roller		option	option	option	option	option	option	option
Farmtec Spikeroller		option	option	option	option	option	option	option
Rake		option	option	option	option	option	option	option



# The benefits

## The drive-system

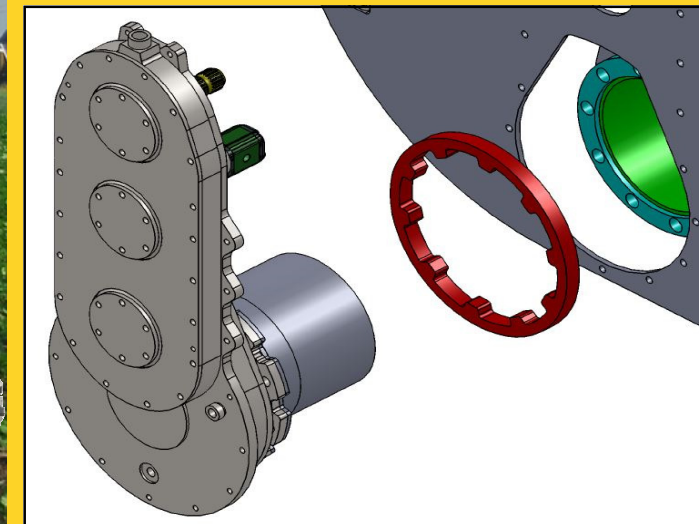

The unique drive-system with planetary at the rotor-shaf, makes this machines to be used for high power up to 400 Hp.

## Choice of 3 model blades



Choice of 3 model blades, for clay, loam and sand. Same machine, only to be adapted with the right blade.

## Version with harrow-roller



The Farmtec Agri working at the field in combination with harrow-roller at a sandy soil.

