

Triolent PS Chisel Cultivators



- ✓ TWO ROWS OF LARGE PLOUGHSHARES
- ✓ WORKING DEPTH 6-35CM
- ✓ STUBBLE PLOUGHING AFTER HARVEST, DEEP SOIL AERATING
- ✓ LOW TRACTION RESISTANCE

Basic Technical Characteristics of the Machine:

- ✓ All-area stubble ploughing after harvest with intense mixing effect
- ✓ Soil processing up to the depth of 35 cm, ploughing substitution
- ✓ Excellent incorporation of plant residues into the soil



High Performance

High working speed of up to 12 km/h

Low traction resistance and excellent soil mixing thanks to the optimized ploughshare shape

Excellent permeability of plant residues thanks to the ploughshare spacing of 290 mm

High Work Quality

The top ploughshare part is shaped as a spiral for controlled soil flow

Maintenance-free working bodies equipped with a wide plate for minimum wear and tear



Well-tested design of ploughshares made from extremely high-strength steel; Resistant and maintenance-free spring protection with a high release force

Easy Operation

- ✓ Minimum number of adjusting spots
- ✓ Minimum number of lubrication spots



Easy setting of the working depth using piston-rod spacers on the rollers



Unused spacers can be placed at the prepared storage point near the piston-rods; they are always available



Height-adjustable covering disks with easy adjustment, suspended with rubber elements



Highly dimensioned frame from high-strength steel

Smart Frame Design

- ✓ Versatile in field work thanks to the short compact design
- ✓ Stable thanks to the short design and light axle



Greater stability and speed of turning at the headland thanks to the possibility of turning using all rollers



Suspended covering disks for high-quality soil surface levelling



Patented folding system that allows folding the machine with the coverage of 7.9 m into the transportation width of 3 m and height of 4 m, which meets the regulations for operation on roads.

Wide Selection of Rollers – Optional Equipment

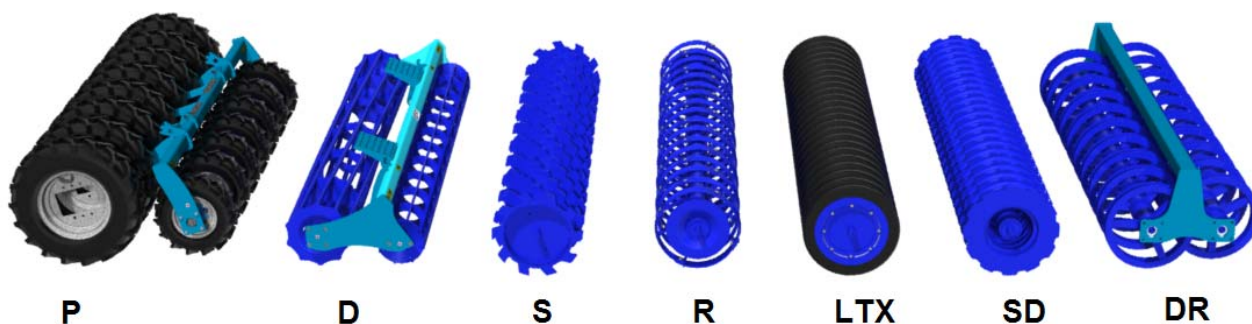

	P	D	S	R	LTX	SD	DR
Name of the Roller	Pneumatic-tyred Roller	Double Roller	Segmented Roller	Ring Roller	LTX Roller	Disk Roller	Double Ring Roller

Roller Ø (mm)	820 / 200	400 / 300	540	500	586	580	540 / 540
Roller weight (kg/m)	195	135	175	160	200	215	180
Crumbling	●●●○	●●●○	●●○○	●●●○	●●○○	●●●○	●●●○
Compacting	●●●●	●●●○	●●●○	●●●●	●●●●	●●●●	●●●●
Depth guiding	●●●●	●●●●	●●●●	●●●●	●●●●	●●●●	●●●●
Resistance to clogging	●●●●	●●●○	●●●●	●●●●	●●●○	●●●○	●●●●
Suitable for rocky soils	●●●●	●●●○	●●●○	●●●○	●●●○	●●●○	●●●○
Suitable for wet soils	●●●●	●●○○	●●●●	●●●●	●●●●	●●●●	●●●●
Heavy soils	●●●●	●●●●	●●●●	●●●●	●●●●	●●●●	●●●●
Medium soils	●●●●	●●●●	●●●●	●●●●	●●●●	●●●●	●●●●
Light soils	●●●●	●●●●	●●○○	●●●●	●●○○	●●○○	●●●●

Optional Chisel Selection – Basic Equipment



Chisel with winglets for all-area soil undercut when working in depths of up to 20 cm



Chisel without winglets for deep aeration up to the depth of 35 cm with low traction resistance



Slim chisel for very deep aeration up to the depth of 38 cm

Options for the ploughshares selection that bring many advantages:

- ✓ Favourable geometry for the entire service life
- ✓ Excellent penetration into hard soil
- ✓ Low traction resistance
- ✓ Suitable for rocky soils
- ✓ Up to 15 % less fuel consumption

SLIM 75 Share



3002317

Share width: 75 mm
Share thickness: 12 mm
Working depth: 6 - 35 cm
Share body hardness: up to 55 HRC

SLIM 75 CARBIDE Share



4005271

Share width: 75 mm
Share thickness: 15 mm
Working depth: 6 - 35 cm
Share body hardness: up to 55 HRC
Widia plate hardness: up to 92 HRA
Service life: up to 3x longer

SLIM 75 CARBIDE⁺ Share



4009627

Share width: 75 mm
Share thickness: 15 mm
Working depth: 6 - 35 cm
Share body hardness: up to 55 HRC
Widia plate hardness: up to 92 HRA
Weld deposit hardness: up to 60 HRC
Service life: up to 3x longer

SLIM 40 CARBIDE Share



4007998

Share width: 40 mm
Share thickness: 20 mm
Working depth: 6 - 35 cm
Share body hardness: up to 55 HRC
Widia plate hardness: up to 92 HRA
Service life: up to 3x longer

SLIM 40 CARBIDE⁺ Share



4010045

Share width: 40 mm
 Share thickness: 20 mm
 Working depth: 6 - 35 cm
 Share body hardness: up to 55 HRC
 Widia plate hardness: up to 92 HRA
 Weld deposit hardness: up to 60 HRC
 Service life: up to 4x longer

SLIM 40 DEEP CARBIDE⁺ Share



4008453

Share width: 40 mm
 Share thickness: 20 mm
 Working depth: 10 - 39 cm
 Share body hardness: up to 55 HRC
 Widia plate hardness: up to 92 HRA
 Weld deposit hardness: up to 60 HRC
 Service life: up to 4x longer

ULTRA SLIM 20 DEEP CARBIDE⁺ Share



4010048

Share width: 20 mm
 Share thickness: 20 mm
 Working depth: 9 - 38 cm
 Share body hardness: up to 55 HRC
 Widia plate hardness: up to 92 HRA
 Weld deposit hardness: up to 60 HRC
 Service life: up to 4x longer

Technical Parameters

PARAMETERS	TRIOLENT 600 PS	TRIOLENT 800 PS
Working width (mm)	6 200	7 900
Transport width (mm)	3 000	3 000
Transport height (mm)	3 300	4 000
Total length of the machine (mm)	7 495	7 495
Working depth (mm)	60 - 300	60 - 300
Number of ploughshares	19	25
Number of rows of ploughshares	3	3
Row distance (mm)	780	780
Ploughshare spacing (mm)	290	290
Frame clearance (mm)	880	880
Release force (kg)	450	450
Covering disk diameter (mm)	460	460
Working capacity (ha/h)	4.8 - 7.2	6.4 - 9.6
Pulling vehicle (kW/HP)	245 - 370 / 330 - 500 ¹⁾	295 - 440 / 400 - 600 ¹⁾
Working speed (km/h)	8 - 12	8 - 12
Maximum transport speed (km/h)	25	25
Maximum climbing ability (°)	6	6
Tyre dimensions - transport	19.0/45-17	19.0/45-17
Type of brakes / distribution ⁵⁾	air / two-line ³⁾	air / two-line ³⁾
Required pressure (kPa)	8.5 ³⁾	8.5 ³⁾
Number of hydraulic circuits / pressure (bar)	3 / 200	3 / 200
Number of quick-coupling devices / type	6 / ISO 12.5	6 / ISO 12.5
Tractor hitch requirement	TPH Cat. 3	TPH Cat. 3
Machine weight (kg)	6 750 ²⁾	7 550 ²⁾

¹⁾ recommended pulling vehicle, the actual pulling force may significantly change according to the selected version of the machine, processing depth, soil conditions, inclination of land, wear and tear of the working parts and their adjustment
²⁾ weight of the machine with the LTX roller
³⁾ alternative to the hydraulic brake / operating pressure 130±5 bar

Technical Advice!

¹⁾ **Transport:** Follow the national regulations valid for transportation of machines on public roads. Check the legal provisions valid in the country and regulations on maximum permissible total axle weights. If you have any further questions, please contact our sales representative.

Hitch Alternatives

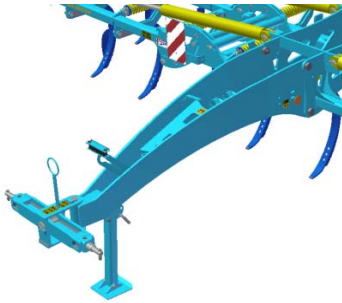

TPH, Category III

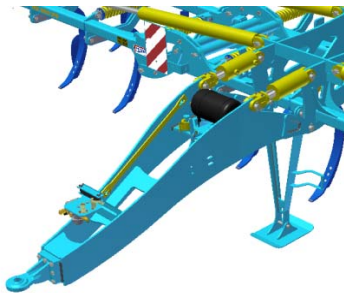

Bottom hitch eye ř 50 mm

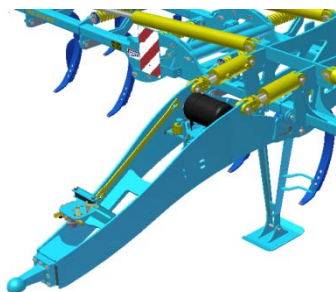

K80 hitch ř 80 mm

Optional Equipment



Set of pins for TPH, Category IV



Light set



Two-line single-circuit air pressure brakes (a part of standard equipment)

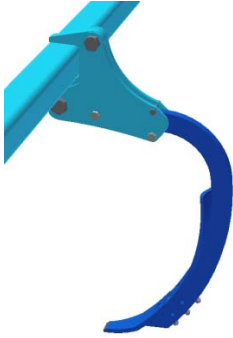

Protection by a break screw (to be used in non-rocky soils)



Light set

eXtra STEEL line®

V roce 2008 aplikována nová speciální technologie výroby eXtra STEEL line, která umožňuje použití vysoce pevných zušlechťených materiálů nejen na pracovních orgánech stroje, ale i na extrémně zatěžovaných částech hlavních rámců a seřizovacích mechanismů. Rámy strojů jsou na velmi exponovaných místech tvořeny dílci z vysokopevnostních ocelí dosahujících několikanásobnou pevnost oproti běžným kvalitním konstrukčním materiálům. Díky technologii eXtra STEEL line je dosahováno nižší hmotnosti strojů a výrazně vyšší životnosti v nejnáročnějším provozu.

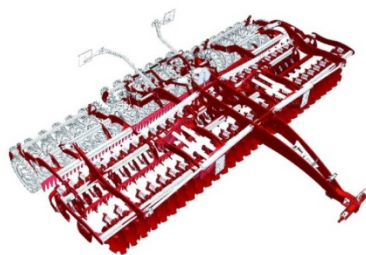
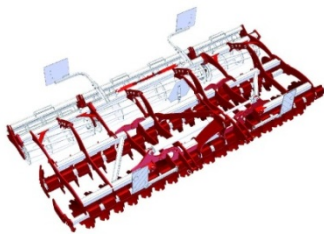

More information at www.farmet.cz

Valid from 1 June 2013; changes reserved.