

Triolent N-NS Chisel Cultivators

- ✓ THREE ROWS OF LARGE PLOUGHSHARES
- ✓ WORKING DEPTH 6-35CM
- ✓ STUBBLE PLOUGHING AFTER HARVEST, DEEP SOIL AERATING
- ✓ LOW TRACTION RESISTANCE



Basic Technical Characteristics of the Machine:

- ✓ All-area stubble ploughing after harvest with intense mixing effect
- ✓ Soil processing up to the depth of 35 cm, ploughing substitution
- ✓ Excellent incorporation of plant residues into the soil



High Performance

High working speed of up to 12 km/h

Low traction resistance and excellent soil mixing thanks to the optimized ploughshare shape

Excellent permeability of plant residues

High Work Quality

The top ploughshare part is shaped as a spiral for controlled soil flow

Maintenance-free working bodies equipped with a wide plate for minimum wear and tear

Robust Frame

- ✓ High-strength refined materials used for crucial nodes to ensure long service life
- ✓ Highly dimensioned frames from high-strength steel



Well-tested design of ploughshares made from extremely high-strength abrasion-resistant steels; Resistant and maintenance-free spring protection with a high release force of 450kg

Easy Operation

- ✓ Minimum number of adjusting spots
- ✓ Minimum number of lubrication spots



Easy setting of the working depth using a pin on the rollers



Height-adjustable covering disks with a practical handle for better setting ergonomics

Wide Selection of Rollers

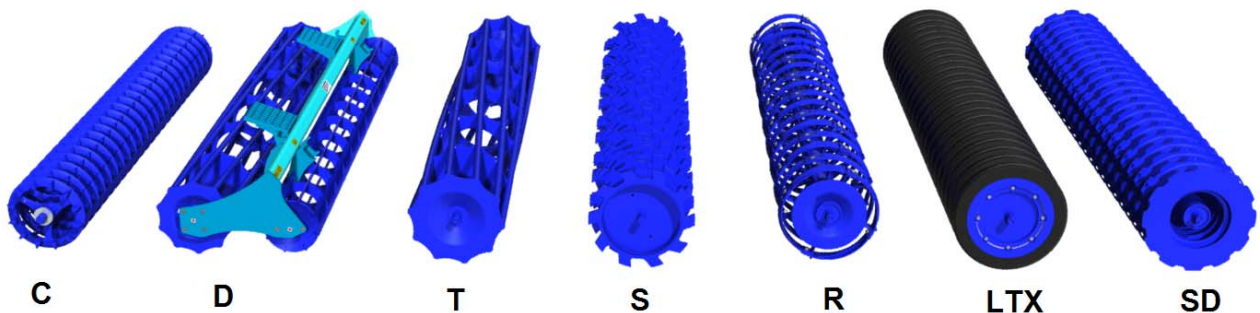

	C	D	T	S	R	LTX	SD
Name of the Roller	Crosskill Roller	Double Roller	Tubular roller	Segmented Roller	Ring Roller	LTX Roller	Disk Roller
Roller Ø (mm)	400	400 / 300	510	540	500	586	580
Roller weight (kg/m)	185	135	90	175	160	200	215
Crumbling	●●●●	●●●○	●●○○	●●○○	●●○○	●●○○	●●○○
Compacting	●●●●	●●●○	●●●○	●●●○	●●●●	●●●●	●●●●
Depth guiding	●○○○	●●●●	●●●○	●●●●	●●●●	●●●●	●●●●
Resistance to clogging	●●○○	●●●○	●○○○	●●●●	●●●●	●●○○	●●○○
Suitable for rocky soils	●●○○	●●●○	●●●○	●●●○	●●○○	●●○○	●●○○
Suitable for wet soils	●●○○	●●○○	●○○○	●●●●	●●●●	●●●●	●●●●
Heavy soils	●●●●	●●●●	●●○○	●●●●	●●●●	●●●●	●●●●
Medium soils	●●●○	●●●●	●●●○	●●●●	●●●●	●●●●	●●●●
Light soils	●●○○	●●●●	●●●●	●●○○	●●●●	●●○○	●●●●

Optional Chisel Selection



Chisel with winglets for all-area soil undercut when working in depths of up to 20 cm



Chisel without winglets for deep aeration up to the depth of 35 cm with low traction resistance



Slim chisel for very deep aeration up to the depth of 38 cm

Options for the ploughshares selection that bring many advantages:

- ✓ Favourable geometry for the entire service life
- ✓ Excellent penetration into hard soil
- ✓ Low traction resistance
- ✓ Suitable for rocky soils
- ✓ Up to 15 % less fuel consumption

SLIM 75 Share



3002317

Share width: 75 mm
Share thickness: 12 mm
Working depth: 6 - 35 cm
Share body hardness: up to 55 HRC

SLIM 75 CARBIDE Share



4005271

Share width: 75 mm
Share thickness: 15 mm
Working depth: 6 - 35 cm
Share body hardness: up to 55 HRC
Widia plate hardness: up to 92 HRA
Service life: up to 3x longer

SLIM 75 CARBIDE⁺ Share



4009627

Share width: 75 mm
Share thickness: 15 mm
Working depth: 6 - 35 cm
Share body hardness: up to 55 HRC
Widia plate hardness: up to 92 HRA
Weld deposit hardness: up to 60 HRC
Service life: up to 3x longer

SLIM 40 CARBIDE Share



4007998

Share width: 40 mm
Share thickness: 20 mm
Working depth: 6 - 35 cm

Share body hardness: up to 55 HRC
Widia plate hardness: up to 92 HRA
Service life: up to 3x longer

SLIM 40 CARBIDE⁺ Share



4010045

Share width: 40 mm
Share thickness: 20 mm
Working depth: 6 - 35 cm

Share body hardness: up to 55 HRC
Widia plate hardness: up to 92 HRA
Weld deposit hardness: up to 60 HRC
Service life: up to 4x longer

SLIM 40 DEEP CARBIDE⁺ Share



4008453

Share width: 40 mm
Share thickness: 20 mm
Working depth: 10 - 39 cm

Share body hardness: up to 55 HRC
Widia plate hardness: up to 92 HRA
Weld deposit hardness: up to 60 HRC
Service life: up to 4x longer

ULTRA SLIM 20 DEEP CARBIDE⁺ Share



4010048

Share width: 20 mm
Share thickness: 20 mm
Working depth: 9 - 38 cm

Share body hardness: up to 55 HRC
Widia plate hardness: up to 92 HRA
Weld deposit hardness: up to 60 HRC
Service life: up to 4x longer

Technical Parameters

PARAMETERS	TX 300 N	TX 350 N	TX 380 NS	TX 470 NS
Working width (mm)	3 000	3 500	3 800	4 700
Transport width (mm)	3 000	3 500	2 300	3 000
Transport height (mm)	1 400	1 400	2 500	2 500
Total length of the machine (mm)	4 060	4 060	4 050	4 050
Working depth (mm)	60-350	60-350	60-350	60-350
Number of ploughshares	10	13	13	16
Number of rows of ploughshares	3	3	3	3
Row distance (mm)	780	780	780	780
Ploughshare spacing (mm)	290	290	290	290
Frame clearance (mm)	880	880	880	880

Release force (kg)	450	450	450	450
Covering disk diameter (mm)	460	460	460	460
Working capacity (ha/h)	2.4 – 3.6	2.8 – 4.2	3.1 – 4.5	3.7 – 5.6
Pulling vehicle (kW/HP) *	110–165/150–225	120–175/160–240	125–190/170–255	150–220/200–300
Working speed (km/h)	8-12	8-12	8-12	8-12
Maximum transport speed (km/h) ¹⁾	20	20	20	20
Maximum climbing ability (°)	6	6	6	6
Number of hydraulic circuits / pressure (bar)	-	-	1 / 200	1 / 200
Number of quick-coupling devices / type	-	-	2 / ISO 12.5	2 / ISO 12.5
Tractor hitch requirement	TPH Cat. 3	TPH Cat. 3	TPH Cat. 3	TPH Cat. 3
Machine weight (kg)**	1680	1920	2655	3010

* recommended pulling vehicle, the actual pulling force may significantly change according to the selected version of the machine, processing depth, soil conditions, inclination of land, wear and tear of the working parts and their adjustment
 ** weight with the double roller - D

Technical Advice!

1) **Transport:** Follow the national regulations valid for transportation of machines on public roads. Check the legal provisions valid in the country and regulations on maximum permissible total axle weights. If you have any further questions, please contact our sales representative.

Optional Equipment

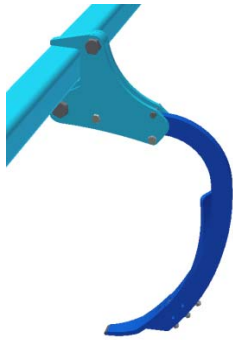

Protection by a break screw (to be used in non-rocky soils)



Light set



Set for the Kirovec hitch

extra STEEL line®

V roce 2008 aplikována nová speciální technologie výroby extra STEEL line, která umožňuje použití vysoce pevných zušlechťených materiálů nejen na pracovních orgánech stroje, ale i na extrémně zatěžovaných částech hlavních rámců a

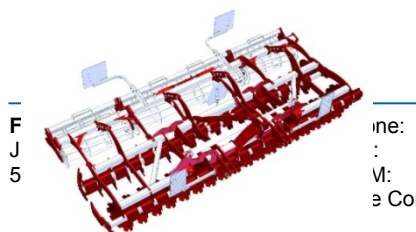

F
J
5

ne:
:
VI:
e Co

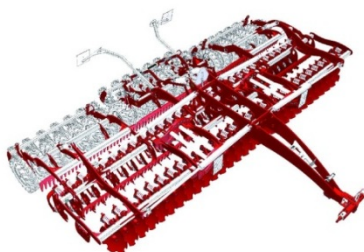

1
931
Court

:
.cz
s3

seřizovacích mechanismů. Rámy strojů jsou na velmi exponovaných místech tvořeny díly z vysokopevnostních ocelí dosahujícími několikanásobnou pevnost oproti běžným kvalitním konstrukčním materiálům. Díky technologii eXtra STEEL line je dosahováno nižší hmotnosti strojů a výrazně vyšší životnosti v nejnáročnějším provozu.

More information at www.farmet.cz

Valid from 1 June 2013; changes reserved.